

50HZ 60HZ

ZT0074_Ec
0914
Supersedes
0312

"POND-MATE"

MODEL 374



Non-Automatic

Features

- For 24 hours continuous run.
- Non-toxic seal chamber grease for continuous run.
- Durable SiC/Carbon seal.
- Thermal overload protected motor for long life.
- Engineered thermoplastic and stainless steel components provide improved corrosion resistance.
- Vent hole prevents air lock.
- Non clogging vortex impeller passes up to 3/8"(9mm) spherical solids.
- Garden hose adapter for easy hookup.
- Carrying handle for convenient pump placement.
- 1-1/2" NPT discharge.
- Standard 9'(2.7m) cord. 33'(10m), 20'(6.1m) cord available upon request.
- Maximum operating water temperature 104°F (40°C).
- 100% tested before shipment for reliable operation.
- One-year limited warranty.

Construction

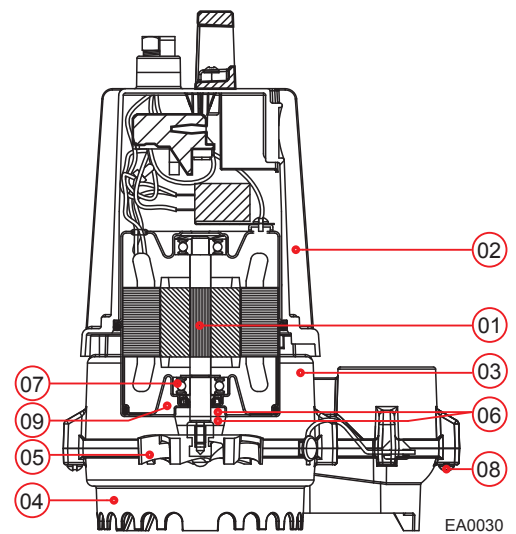

No.	Component	Material
01	Shaft	SUS 420J2
02	Motor Housing	ENGINEERED THERMOPLASTIC + FIBERGLASS
03	Pump Housing	
04	Base	
05	Impeller	
06	Mechanical Seal	SiC / CARBON
07	Seal and Gasket	NBR
08	Hardware	STAINLESS STEEL
09	Grease	Non-Toxic Food Grade

Application

- Fish pond circulation.
- Waterfall landscape.



PUMP COMPANY

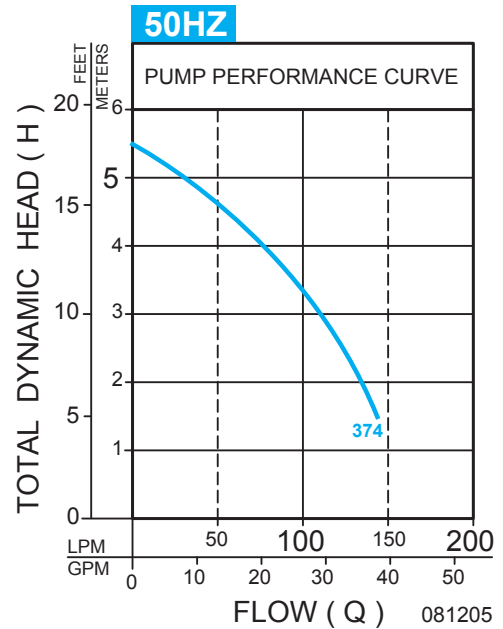
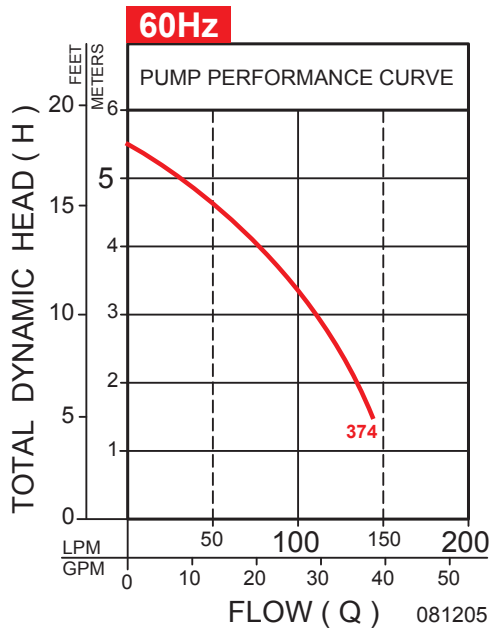

60Hz

Model	Volts	Phase	Hertz	HP	Mode	Amps	Weight (lbs / Kg)	5'TDH / 1.5M (GPM / L/M)	10'TDH / 3.0M (GPM / L/M)	15'TDH / 4.6M (GPM / L/M)	Shut-Off Head (ft. / m)
N374	115	1	60	0.3	Non-Auto	3.1	9.7 / 4.4	38 / 144	30 / 114	14 / 53	18 / 5.5
BL374	220	1	60	0.3	Non-Auto	1.6	9.7 / 4.4	38 / 144	30 / 114	14 / 53	18 / 5.5

50HZ

Model	Volts	Phase	Hertz	HP	Mode	Amps	Weight (lbs / Kg)	5'TDH / 1.5M (GPM / L/M)	10'TDH / 3.0M (GPM / L/M)	15'TDH / 4.6M (GPM / L/M)	Shut-Off Head (ft. / m)
V374	220	1	50	0.3	Non-Auto	2.0	9.7 / 4.4	38 / 144	30 / 114	14 / 53	18 / 5.5



**Consult factory for certification availability.

*Intended for indoor use only.

Product information presented here reflects conditions at time of publication.
Consult factory regarding discrepancies or inconsistencies.



PUMP COMPANY

Zoeller Family of Water Solutions™